

Amadeus Diamond

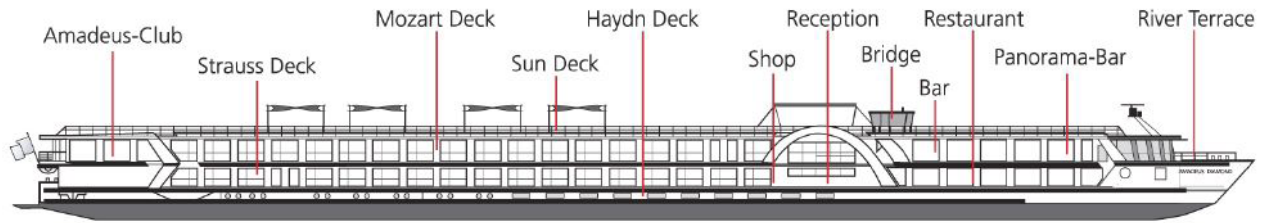

SUN DECK

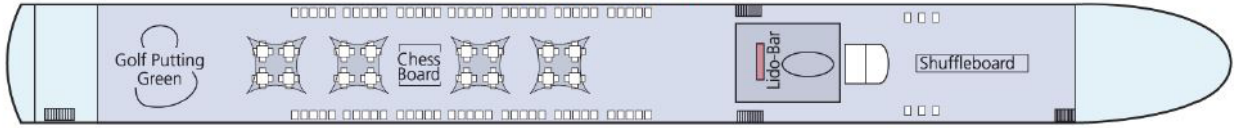

MOZART DECK



STRAUSS DECK

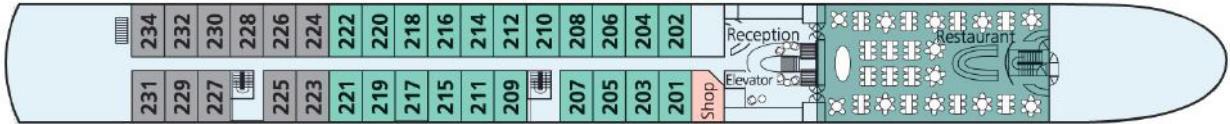

HAYDN DECK

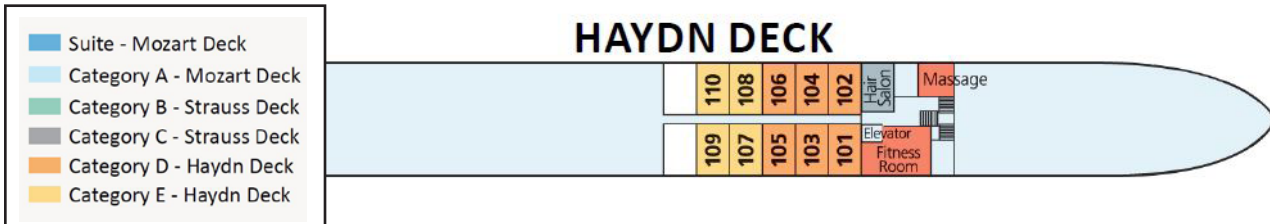

- Suite - Mozart Deck
- Category A - Mozart Deck
- Category B - Strauss Deck
- Category C - Strauss Deck
- Category D - Haydn Deck
- Category E - Haydn Deck

The Ship - MS Amadeus Diamond

The 144-passenger *MS Amadeus Diamond* has been a highlight of the fleet since 2009, and will be the new jewel of the French waterways after its complete renovation for 2019. The extensive Restaurant and the Panorama Bar offer divine views of the passing riverscapes. The 60-staterooms & 12-suites are bright, modern and provide a wonderful private space to enjoy your river cruise. The attentive English speaking onboard staff will see to your comfort. This Diamond charter features inclusive sightseeing excursions balanced with choice to simply relax onboard, get a spa treatment or add sightseeing with optional excursions.

All Meals Included Onboard

Three meals daily are served graciously in the exquisite restaurant and feature local & international specialties. All dinners are four courses and are served with included Regional Wines & Beer. While dining, you have splendid views of the passing scenic landscapes through the large picture windows. Enjoy afternoon and/or late evening snacks in the lounge based on the daily schedule.

Comfortable & Modern Staterooms

After boarding, unpack only once. All staterooms onboard offer excellent river views and are bright, modern and inviting giving you a space of your own with all the amenities and pleasant touches of an upscale hotel. The Mozart & Strauss Decks feature suites and staterooms with French Balconies. Staterooms on the Haydn Deck have a fixed window. Each stateroom is fully equipped with comfortable & modern furnishings including flat screen TV, individual heating/air conditioning controls, safe, phone, hair dryer and a private bathroom with shower.



Staterooms (162 sq ft)

Staterooms feature 2 twin beds that can be separated or put together, flat screen TV, hair dryer, private bath with shower, closet, phone, desk, chair & safe. Floor to ceiling sliding glass doors with French Balcony on Mozart & Strauss Decks. Fixed window on Haydn Deck.



SUITE - 237 SQ FT WITH BALCONY

All suites are on the Mozart Deck and have panoramic windows with exterior Walk Out Balcony, two twin beds that can be separated or put together, a private sitting area, flat screen TV, mini-bar, private bath with shower, hair dryer, phone, closet, desk, chair, safe & offer 237 square feet of floor space.

(Suite size and amenities can vary)

Standard Cabin(162 sf)

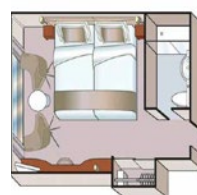

Suite Mozart Deck (237 sf)

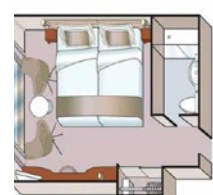

SHIP TECHNICAL DATA

Refurbished/Built: 2019/2009
Length/Width (ft): 361/36.5

Decks/Crew members: 4/40
Cabins/Suites: 60/12